

THE BLUE BIRD **WANDERLODGE LXi**



THE BLUE BIRD **WANDERLODGE LXi**





LIFE BEGINS AT 65 MPH.



You've waited a lifetime for this moment. The chance to explore America and live the fantasy. And for you, only one motorcoach will do: the Wanderlodge LXi by Blue Bird. A vehicle that redefines the concept of luxury, and rewards your discerning taste. There simply is no better way to start your journey.

LXi

3

THE BLUE BIRD WANDERLODGE LXi





IT'S TIME TO EXPAND YOUR HORIZONS.

Slide-out rooms at the front and rear of the LXi create generous living space inside.



THE BLUE BIRD WANDERLODGE LXi



Having already filled our motorcoaches with every conceivable luxury, we at Blue Bird considered how to widen our appeal. The answer was quite moving indeed: the Wanderlodge LXi's unique slide-out feature. With the vehicle at rest, the walls in both the living room/galley and bedroom expand to provide an additional 200 cubic feet of living space. Luxury, after all, needs plenty of room to breath.





ULTIMATE LUXURY: DISCOVER THE INSIDE STORY.

LXi slide-out interior with dual couch living area.



You've always insisted on surrounding yourself with the very best. So isn't it nice to know that one motorcoach meets your exacting standards? That's the story inside each and every Wanderlodge LXi. Blue Bird has designed a vehicle of impeccable quality, a living environment that rivals the finest homes without wheels.

LXi

7

THE BLUE BIRD WANDERLODGE LXi



LXi slide-out interior with couch/credenza living area.



Every Wanderlodge LXi can be customized with the finest leather seating, in a wide variety of colors to suit your particular taste.



QUALITY STARTS WITH THE FINISHING TOUCHES.

LXi bedroom with queen size bed and mirrored walk-in closet.



No other vehicle offers the breadth of amenities or the quality of material you'll find on board a Wanderlodge LXi. Blue Bird employs the industry's most experienced collection of designers, artisans, and craftsman to create the rich surroundings of this magnificent vehicle, from the hand-made cabinetry and in-laid carpeting to the state-of-the-art components that put every convenience at your fingertips. It's an amazing experience from start to finish.



THE BLUE BIRD WANDERLODGE LXi



*LXi bathroom with
tile floor and cherry
wood cabinetry.*





GREAT ENGINEERING ISN'T A LUXURY. IT'S A NECESSITY.



*Detroit Diesel Series
60 500-hp engine*



*Purpose-built
all-steel chassis*



*Steel body
construction*



A life on the road demands everything from a vehicle. Strength. Durability. Reliability. And the Wanderlodge LXi has been designed with just such a life in mind. The LXi features a 500-hp Detroit Diesel Series 60 engine and Allison six-speed World transmission, mounted on the industry's most

THE BLUE BIRD WANDERLODGE LXi



RVIA

*Every Wanderlodge LXi
undergoes a strict certification
process by the RVIA.*

capable all-steel, purpose-built chassis. Blue Bird technicians then construct a formidable steel body that's welded and riveted to the undercarriage to create an integrated vehicle design that can stand up to anything the road may offer.



SPECIFICATIONS

43'

STANDARD FEATURES

LIVING FEATURES

- o Natural oak cabinetry
- o Custom floor plans & interiors
- o Walk-in bedroom closet
- o Alpine premium sound system in dash with 10-disc CD player
- o AM/FM cassette stereo in bedroom
- o Two 20" remote control televisions
- o Stereo VCR connected to both TVs
- o Solid-surface countertops in living room, galley and bedroom
- o Thermolite vanity & shower walls
- o Fully-tiled kitchen and bath floors
- o Leather six-way power adjustable pilot & co-pilot seats
- o Air ride base on pilot seat
- o Dometic refrigerator/freezer/ice maker
- o Sharp micro-convection oven
- o Instant Hot water dispenser
- o Two-burner LP cook top
- o Aqua Hot diesel-fired, 3-zone hot water heat system with heat for plumbing bay
- o Electric heat in both living room and bath
- o Water purification system
- o Fantastic Fan in bath with rain sensor
- o Three 13,500-BTU low-profile fully-ducted roof airs with heat strips
- o 40-channel CB radio and radar detector
- o Compass/thermometer
- o Solid-state musical horn
- o Musical door bell
- o Dual remote-control and heated outside rearview mirrors
- o Electronic lock at entrance door
- o Air lock on entrance door
- o Automatic cabinet lighting
- o TV coaxial connection in the bay
- o Under bed storage with gas cylinder lift assist
- o Air operated dump valves for holding tanks
- o Safeline shoreline alarm

MECHANICAL FEATURES

- o Detroit Diesel Series 60 500-hp engine
- o Allison six-speed World transmission
- o Ross TAS-85 integral power steering
- o Tag axle
- o Jacobs engine brake
- o Tilt and telescoping steering column
- o Ridewell air suspension, front, tag, & rear
- o HWH computerized four-point leveling system
- o Generator auto start
- o 300-amp alternator
- o 15kW diesel generator in sound-proof roll-out compartment
- o (2) Trace 3000-watt inverters with 140-amp integral chargers
- o 50-amp electrical service

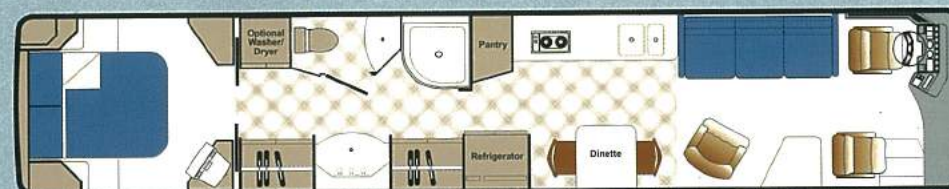

THE BLUE BIRD WANDERLODGE LXi

- o 315/80R 22.5J 16-ply Michelin steel cord radial tires
- o Battery systems: six 4D gel cell batteries for house, three 12-volt maintenance-free for engine, and one 12-volt for generator
- o Cruise control
- o Heated Racor fuel filter and water separator
- o Auxiliary start switch
- o Engine block heater
- o Ether-injected quick start aid
- o Individual mud flaps, front & full-width rear
- o Electronic master switch
- o Air-operated stepwell cover
- o A/T anti-theft switch

- o LP tank
- o 260-gallon diesel fuel tank with dual fill
- o HVAC automotive dash heat & air system

EXTERIOR FEATURES

- o Polished, hub-piloted aluminum wheels
- o Lowered engine deck
- o Front & rear fiberglass caps
- o Steel body construction
- o 102" wide body; 259" wheelbase
- o Carpet-lined and lighted bus storage area below
- o Foamed-in-place insulation
- o Audible reverse warning system
- o Engine compartment illumination

- o Wired and plumbed for auxiliary air compressor
- o Locking fuel doors
- o Lighted utility center
- o Air-operated entry step
- o Auxiliary air outlet
- o Outside water compartment
- o Daytime running lights
- o Rear brake light
- o Sony rear-vision closed-circuit TV system
- o Back-up flood lamps, high-intensity spot/flood light, & docking lights
- o Roof-mounted TV antenna on power lift
- o Cellular phone antenna
- o Dual air horns on roof
- o Toolbox on slide-out tray
- o Zip Dee full awning package with chairs
- o Keyless entry
- o Electric grill on slide-out tray

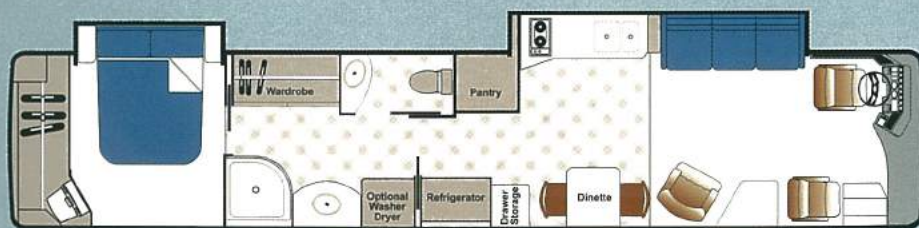

43'

STANDARD FEATURES



Blue Bird Corporation • Wanderlodge Division • One Wanderlodge Way • Fort Valley, Georgia 31030 • 1-800-486-7122 • www.blue-bird.com

A subsidiary of Henlys Group plc



BLUE BIRD

RV-111 700

© 2000 Blue Bird Corporation

Printed in USA

All illustrations and specifications contained in this literature are based on the product information available at the time of publication approval. In some places, artist's renderings have been used. The right is reserved to make changes at any time in prices, colors, materials, equipment, specifications, and models. Due to occasional printing irregularities, the colors may vary from actual hues. See your Blue Bird dealer for accurate color chips and new color combinations, fabrics, etc. other than those depicted herein. Many items are options - your Blue Bird motorcoach dealer will explain. Blue Bird motorcoaches meet and exceed RVIA standards; Blue Book resale value for pre-owned motorhomes is pre-established.