

Complete Technical Specifications

# Wanderlodge M380

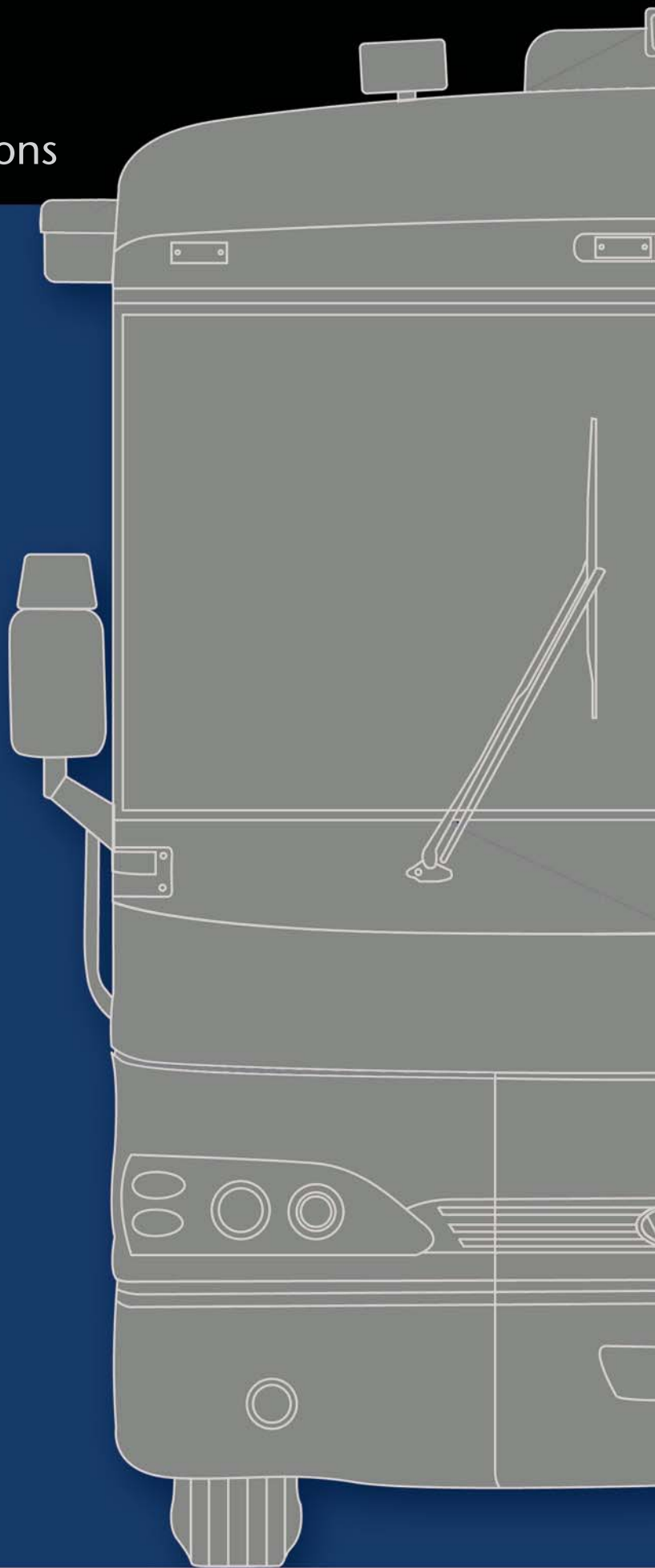

*Experience More.*



### **General Interior:**

- Designer Interior
  - Optional upgrade interior
- Designer Exterior paint designs
  - Optional double clear-coat application
- Solid surface countertops in the living room, kitchen and bedroom.
- Oak Cabinetry with clear coat or whitewashed finish.
  - Optional cabinetry:
    - Cherry with clear-coat or stained
    - Walnut with clear-coat
    - Maple with clear-coat or stained
    - Laminate
- Hidden hinges on cabinetry
- Carpet lined shelves inside cabinetry
- Wallpapered interior walls

### **Pilot/Co-Pilot Area:**

- Grab handles at entrance door
  - Optional brass grab handles
- 20" stereo remote control television
  - Optional 37" Plasma television
  - Optional Universal Remote
- Power TV antenna
- Dual band cellular phone antenna
- AM/FM/CD dash radio, satellite compatible
  - Optional Sirius Satellite radio (requires customer activation)
  - Optional GPS system
- 10-disc CD changer
- Automatic video selector switch with volume stabilizer
- Stereo VHS/VCR with front video input
- 40 channel hand held CB radio
- Color rear vision monitor system
  - Optional musical horn
  - Optional door chime

- Bose 3-2-1- home entertainment center with DVD
- Pre-wire for digital satellite system
  - Optional KVH Trakvision satellite system
- Pre-wire for radar detector at front dash
  - Optional radar detector
- 6-way power adjustable pilot/co-pilot seat with heat
- Power footrest on co-pilot seat
- Power front windshields sun visor
- Pilot/co-pilot window shades
- Dash AC/Heat climate control system
- Air actuated step-well cover
- Vinyl padded decorative entrance door panel

### **Living Area Highlights:**

- Sleeper style sofa covered in designer fabric with accent pillows
  - Optional sleeper sofa covered in ultra leather
- Swivel barrel chair with side table
  - Optional European style recliner and ottoman
  - Optional love seat
  - Optional computer table
- 12 V general task lighting in ceiling
- Fabric covered window boxing with decorative cornice
- Coordinating day/night shades
- Cabinets above living room windows
- Carpeted flooring with premium pad
  - Optional laminate flooring in lieu of carpet

### **Kitchen/Dinette Highlights:**

- Solid Surface galley countertop with accent bull nosing
- Solid Surface dinette table with extension leaf and upholstered chairs
  - Optional booth dinette
- Decorative 120V light above dinette table
- 12V task lighting above countertop
- Fabric covered window boxing and decorative cornice

**2004 38' Wanderlodge  
Floorplan "A"**

Available as Single-Slide or Double-Slide

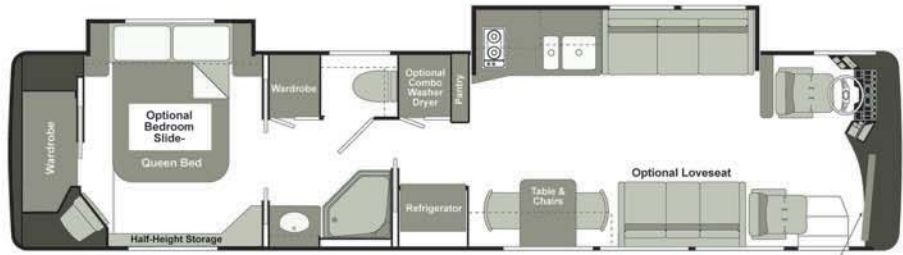
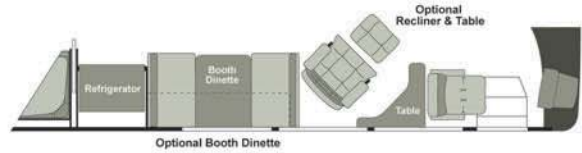
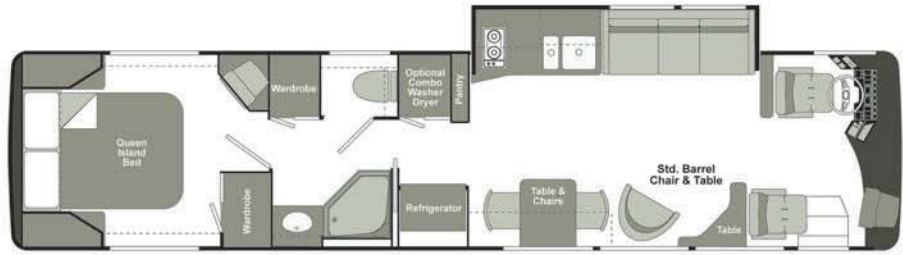

Optional 37" Plasma Television  
in Front Overhead Dash

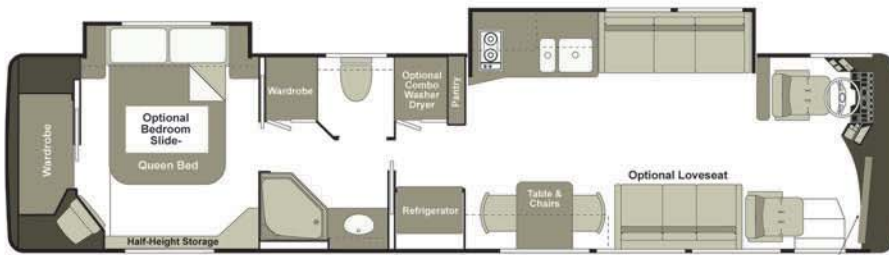
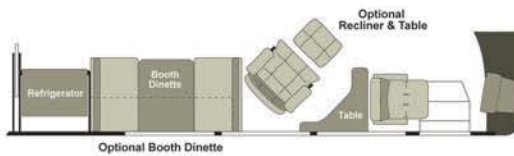
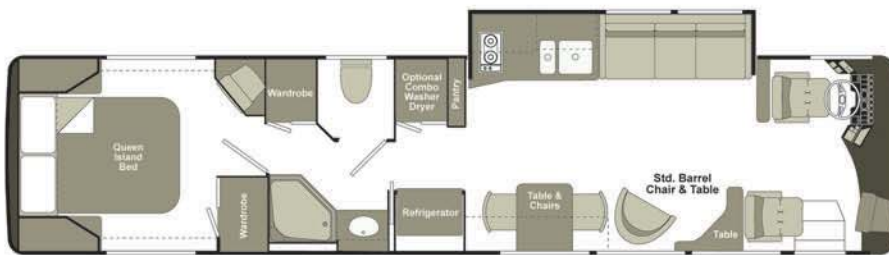

Optional 37" Plasma Television  
in Front Overhead Dash

**2004 38' Wanderlodge  
Floorplan "B"**

Available as Single-Slide or Double-Slide

- Coordinating day/night shade at dinette window
- Beveled mirror strips on kitchen backslash
  - Optional beveled mirror strips on dinette wall
- Recessed LP gas burner cook top
- Microwave/convection over
  - Optional microwave upgrade
- Single lever European faucet
  - Optional Constant hot
- 13.0cu. Ft. Refrigerator with icemaker
- Towel bar/wastebasket/silverware holder
- Laminate flooring
- Pre-wire and plumb for combo washer/dryer beside pantry
  - Optional washer/dryer installed

### ***Bath Highlights:***

- Single lever faucets
- Thermolite vanity tops
- Sealand toilet
  - Optional Microphor toilet
- Fiberglass shower
- Clear shower door
  - Optional etched shower door
- Medicine cabinet with beveled mirrored doors
- Full-length mirror on one bathroom pocket door
- Decorative 120V opera above medicine cabinet
- 12V halogen task lighting in ceiling
- Laminate flooring

### ***Bedroom Highlights:***

- Center island bed (Cross island available with optional bedroom slide-out)
  - Optional bedroom slide-out
- 20" Stereo TV
- AM/FM/CD Radio
  - Optional VCR/DVD player
- 12V halogen task lighting on bottom of overhang cabinets
- Optimal second satellite receiver
- 12V task lighting in ceiling
- Overhead cabinets

## ***Coach Systems:***

### **Electrical**

- 12KW slide-out generator in hush box w/ battery
- 3000 W inverter with 120 AMP battery charger
- (3) 4D AGM batteries for house systems
- 50 AMP automatic cord reel
  - Optional all electric coach (check availability)

### **Air Conditioning**

- 48,000 BTU hydronic heating system
- (2) 15,000 BTU low-profile roof AC's with heat pumps
- Thermostatically controlled electric heater in kitchen and bath
- Fantastic Fan with rain sensor in bath
- Exhaust fan in private toilet

### **Mechanical System**

- Manabloc plumbing system
- Water filtration system
- Drain hose in storage compartment
- Black waste tank with no fuss flush (60 gal)
- Gray water tank (60 gal)
- Freshwater tank (100 gal)
- LP tank (30 gal)

### **Safety Features**

- Fire extinguishers (2) located in co-pilot area and outside bay
- LPG leak detector
- CO detector
- Smoke detectors (2)
- Dead-bolt lock entrance door with keyless entry and security system
- Air lock entrance door



## **Exterior Body Features:**

- Fiberglass front and rear cap with integrated molded bumpers
- Power slide-out generator in front cap
- Sedan-type front entrance door with screen door, key lock and air lock at top
- Electric powered auxiliary entrance doorstep
- Chrome air horns
- Chrome remote control heated, adjustable mirrors
- Dual speed intermittent wipers
- Pantograph engine access door
- Outside luggage compartments
  - Pantograph doors (except under slide rooms) with electric locks
  - Lighted interior, switched with doors
  - Phone, cable, water, electric hook-up compartment
  - Water pump switch located in utility center
  - Under floor pass through luggage
  - Stainless steel bay floor with loose carpet in storage area
  - Wire and plumb for auxiliary air compressor in outside compartment
  - Optional auxiliary air compressor
- **New body construction**
  - Integral steel tubing with continuous aluminum extruded headers
  - Smooth body panel
  - One Piece aluminum roof
- **Exterior Lighting**
  - Hella pre-focused headlights
  - Daytime running lights
  - Fog lights
  - LED exterior marker lights
  - Backup/reverse lights
  - (4) side docking lights
  - Amber fluorescent porch light on curbside and roadside
  - Lighted grab handle next to entrance door
  - Remote control spotlight
- **Mud flaps**
- **Windows**
  - Thermo pane, double insulated windows
- **Awnings**
  - Patio awning on curb side
    - Optional Girard power patio
  - Window awnings over uncovered windows

## **Chassis Features:**

- Integrated body/chassis construction
- Independent front suspension with 54 degree turning angle
- Tilt/telescoping steering column
- Rear air suspension with (4) outboard air bags
- Schrader air outlet
- Four point automatic hydraulic leveling system
- **Axles**
  - 14,600 lb. Front
  - 21,500 lb. Rear
- **Wheels**
  - Hub piloted
  - Steel belted radial tires 12R-22.5
- **Braking System**
  - Front air disc brakes
  - Rear air disc brakes
  - Bendix four channel ABS brakes system with automatic traction control
- **Engine**
  - ISL, 400hp turbo diesel engine with C-brake (engine brake)
  - Fast idle
  - Aluminized steel exhaust system with exit through roof
  - Racor fuel filter with water separator and pre-heater
  - 270 AMP alternator
  - Engine oil cooler
  - Remote engine start switch in engine compartment
  - Automatic heat alarm in engine block heater
  - 1,000 watt engine block heater
- **Transmission**
  - Allison MH3000 six speed automatic transmission with electronic shifter
  - Transmission oil cooler
- **Engine Batteries**
  - (2) 12V batteries wired parallel for coach starting
  - Battery cut-off switch in engine compartment
- **Two eyes (2) located at front of coach**
- **Hitch receiver 10,000 lbs.**

# Wanderlodge M380

Blue Bird Corporation  
Wanderlodge Division  
One Wanderlodge Way  
Fort Valley, GA 31030  
1-800-486-7122  
[www.blue-bird.com](http://www.blue-bird.com)

BLUE BIRD  
**Wanderlodge**

*Experience More.*