

## Section VII

### Springs and Shock Absorbers

Springs used on Blue Bird chassis are manufactured by the Service Spring Co., Indianapolis, Indiana.

Gabriel and Delco Shock Absorbers are used exclusively on Blue Bird Chassis and replacement parts may be obtained locally.

Illustrations and parts list are included to aid you in ordering the correct replacement parts for your chassis.

ALWAYS GIVE PART NUMBER FOR EACH PART AND COMPLETE DESCRIPTION AND MANUFACTURER WHEN ORDERING PARTS.

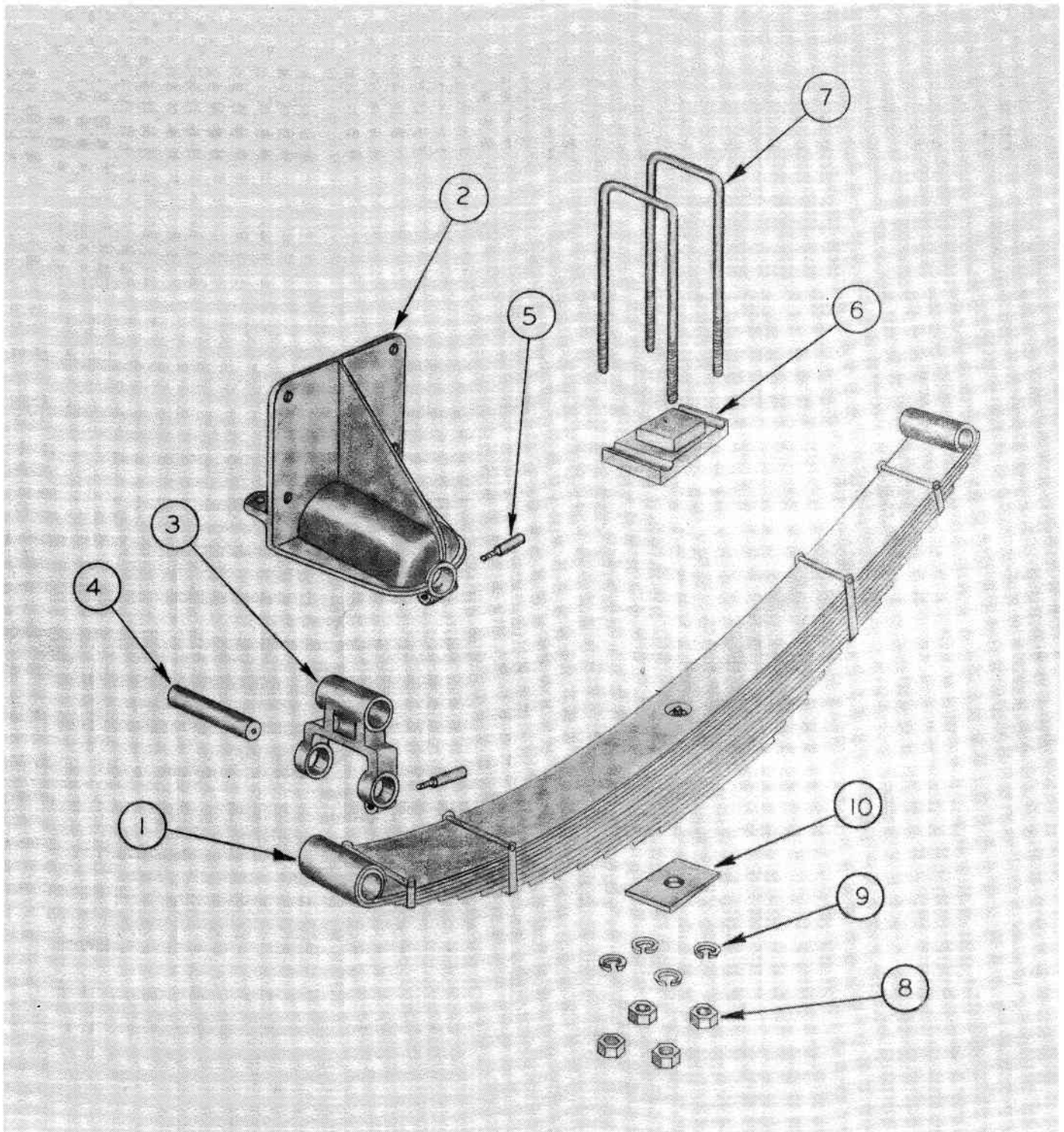

FRONT SPRING GROUP

KEY NO.	PART NO.	PART NAME	APPLICATION	QTY.
1	25250	Spring, 2 1/2" x 52" x 14 leaf	2 1/2" springs	2
1	25251	Spring, 3" x 52" x 13 leaf	3" springs	2
2	11515	Bracket, front spring hanger	2 1/2" springs	4
2	11034	Bracket, front spring hanger	3" springs	4
3	8992-A	Shackle Assembly, Spring	2 1/2" Springs	2
3		Shackle, Ford #7ER-5777	3" springs	2
4		Pin, Spring, Ford #01T-5780	2 1/2" springs	6
4		Pin, spring, Ford #7E}-5780	3" Springs	6
5		Lock, Spring Pin, Ford #81T-5782	All	6
6	18015	Saddle, front spring	2 1/2" springs	2
6	18016	Saddle, front spring	3" springs	2
7	7568 --	"U" bolt, front spring, 3/4" dia.	2 1/2" springs	4
7	11035-8 3/4	"U" bolt, front spring, 3/4" dia.	3" springs	4
8	13410	Nut, front spring "U" bolt, 3/4-16 NF-2B	All	8
9		Lockwasher, front spring "U" bolt, 3/4-.279x.241 Extra heavy	All	8
10	25241	Caster Wedge, 3°	All	2

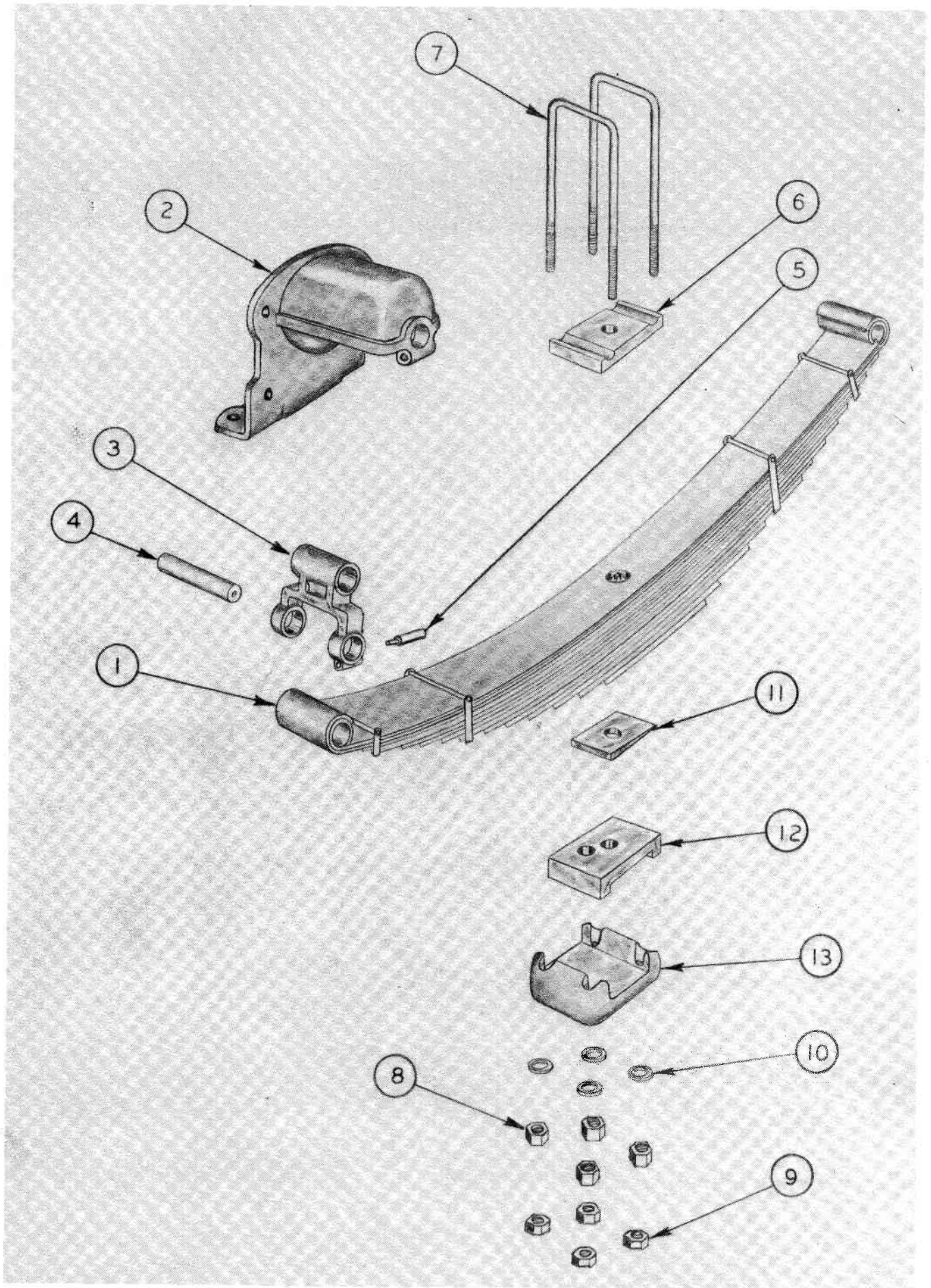

REAR SPRING GROUP

KEY NO.	PART NO.	PART NAME	APPLICATION	QTY
1	25250	Spring, 2 1/2 x 52 x 14 leaf	2 1/2" springs	2
1	25251	Spring, 3 x 52 x 13 leaf	3" springs	2
2	8796	Bracket, rear spring hanger	2 1/2" springs	4
2	-	Bracket, rear spring hanger, Ford #TFAA-5775-A	3" springs	4
3	8992-A	Shackle Assy., spring	2 1/2" springs	2
3	=	Shackle, spring, Ford #7EQ-5777	3" springs	2
4	=	Pin, spring, Ford #01T-5780	2 1/2" springs	6
4	=	Pin, spring, Ford #7EQ-5780	3" springs	6
5	-	Lock, spring pin, Ford #81T-5782	All	6
6	14444	Saddle, rear spring	2 1/2" springs	2
6	14452-	Saddle, rear spring	3" springs	2
7	14443=15	"U" bolt, rear spring, 1" dia.	2 1/2" springs	4
7	14451-15 1/2	"U" bolt, rear spring, 1" dia.	3" springs	4
8		Nut, rear spring "U" bolt, 1-14 NF-2B, Bowman Product Co. #31220	All	8
9		Nut, rear spring, "U" bolt jam, 1-14NF x 35/64 thick	All	8
10		Flatwasher, rear spring "U" bolt, 2" OD x 1 1/32" I.D. x 3/16" thick	All	8
11		Not used		
12	10273	Pad, rear spring, R.H., H-140 and H-340 Axles	2 1/2" springs	1
12	10274	Pad, rear spring, RH, H-140 and H-340 axles	2 1/2" springs	1
12	10274	Pad, rear spring, LH, H-140 and H-340 axles	2 1/2" springs	1
12	10282	Pad, rear spring, RH, L-148 and L-345 axles	2 1/2" springs	1
12	10283	Pad, rear spring, LH, L-148 and L-345 axles	2 1/2" springs	1
12	10893	Pad, rear spring, RH, H-140 and H-340 axles	3" springs	1
12	10894	Pad, rear spring, LH, H-140 and H-340 axles	3" springs	1
12	✓10895	Pad, rear spring, RH, L-148 and L-345 axles	3" springs	1
12	✓10896	Pad, rear spring, LH, L-148 and L-345 axles	3" springs	1
13	14445	Bracket, rear spring, "U" bolt, H-140 and H-340 axles	2 1/2" springs	2
13	14446	Bracket, rear spring, "U" bolt, L-148 and L-345 axles	2 1/2" springs	2
13	14453	Bracket, rear spring, "U" bolt, H-140 and H-340 axles	3" springs	2
13	14454	Bracket, rear spring, "U" bolt, L-148 and L-345 axles	3" springs	2

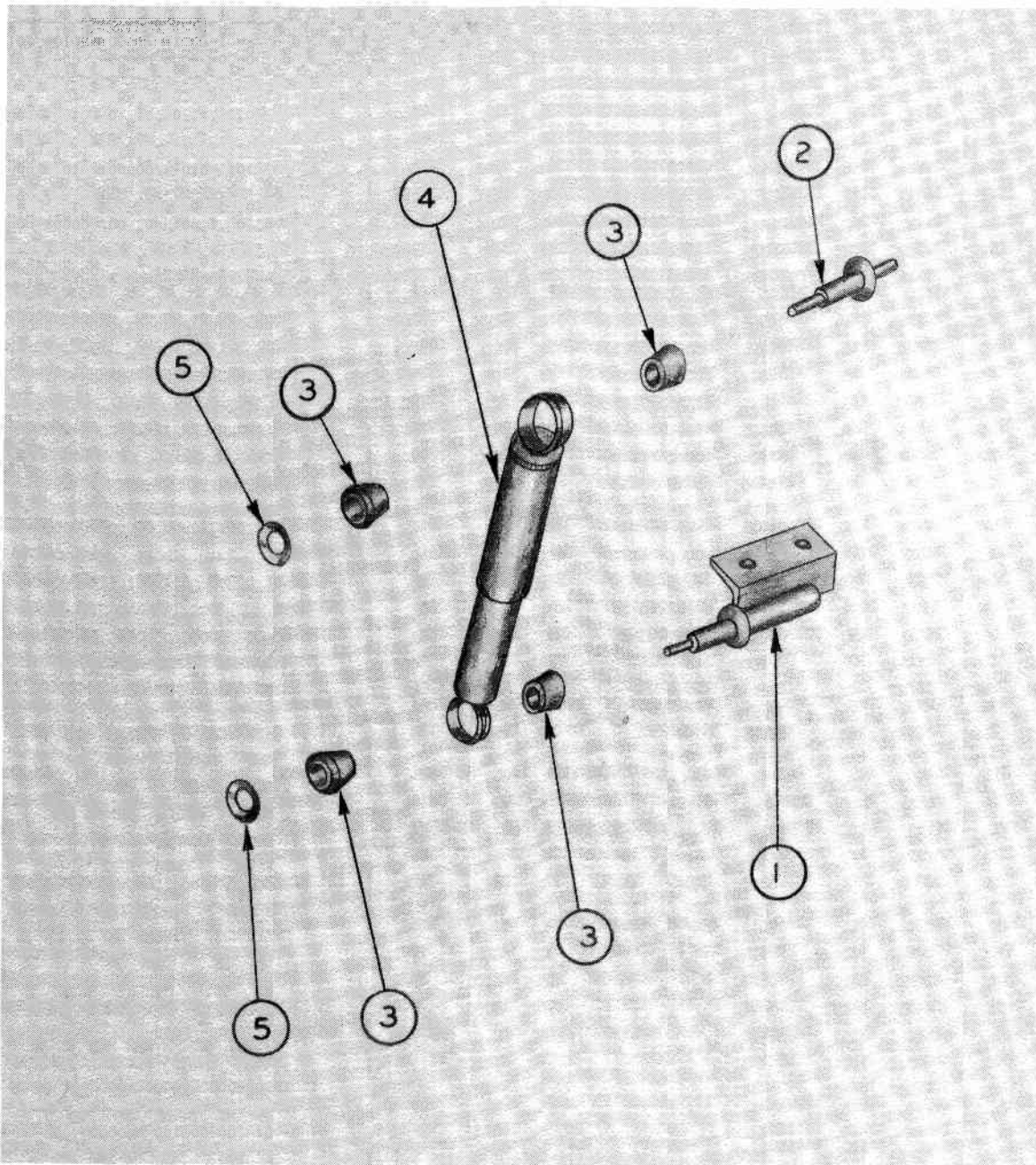

Form #BBC-65-VII-6  
January 4, 1965

FRONT SHOCK ABSORBER GROUP

KEY NO.	PART NUMBER	PART NAME	APPLICATION	QTY.
1	11029-A	Bracket Assy., Shock Absorber to front axle, RH	2 1/2" springs	1
1	11031-A	Bracket Assy., Shock Absorber to front axle, LH	2 1/2" springs	1
1	19268-A	Bracket Assy., Shock Absorber to front axle, RH	3" springs	1
1	19270-A	Bracket Assy., Shock Absorber to front axle, LH	3" springs	1
1	19271-A	Bracket Assy., Shock Absorber to front axle, RH	2 1/2" springs W/H.D. Shock Absorber	1
1	19272-A	Bracket Assy., Shock Absorber to front axle, LH	2 1/2" springs W/H.D. Shock Absorber	1
2	-	Stud Assembly, shock absorber to frame Gabriel #401024	2 1/2" springs	2
2	-	Stud Assy., Shock absorber to frame, Gabriel #401933	3" springs	2
2	-	Stud Assy., Shock Absorber to frame, Gabriel #401933	H.D. Shock Abs.	2
3	-	Bushing, rubber, Gabriel #401011	2 1/2" springs	8
3	-	Bushing, Rubber, Delco #1061603	3" springs	8
3	-	Bushing, rubber, Gabriel #401754	H.D. Shock Abs.	8
4	-	Shock Absorber, Gabriel #57111	2 1/2" springs	2
4	-	Shock Absorber, Delco #5544716	3" springs	2
4	-	Shock Absorber, Gabriel #78139	H.D. Shock Abs.	2
5	-	Washer, retainer, Gabriel #401429	2 1/2" springs	4
5	-	Washer, retainer, Gabriel #401750	3" springs	4
5	-	Washer, retainer, Gabriel #401750	H.D. Shock Abs.	4

REAR SHOCK ABSORBER GROUP

KEY NO.	PART NUMBER	PART NAME	APPLICATION	QTY.
1	14447-A	Bracket Assy., shock absorber to rear axle, RH	2 1/2" springs	1
1	14449-A	Bracket Assy., shock absorber to rear axle, LH	2 1/2" springs	1
1	19254-A	Bracket Assy., shock absorber to rear axle, RH	3" springs	1
1	19256-A	Bracket Assy., shock absorber to rear axle, LH	3" springs	1
1	19258-A	Bracket Assy., shock absorber to rear axle, RH	2 1/2" spring W/H.D. Shock Abs.	1
1	19255-A	Bracket Assy., shock absorber to rear axle, LH	2 1/2" spring W/H.D. Shock Abs.	1
1	24106-A	Bracket Assy., shock absorber to rear axle, RH	Tandem	1
1	24109-A	Bracket Assy., shock absorber to rear axle, LH	Tandem	1
2	-	Stud Assy., shock absorber to frame, Gabriel #401024	2 1/2" springs	2
2	-	Stud Assy., shock absorber to frame, Gabriel #401933	3" springs and Tandem	2
2	-	Stud Assy., shock absorber to frame, Gabriel #401933	H.D. shock abs.	2
3	-	Bushing, rubber, Gabriel #401011	2 1/2" springs	8
3	-	Bushing, rubber, Delco #1061603	3" springs and Tandem	8
3	-	Bushing, rubber, Gabriel #401754	H.D. Shock Abs.	8
4	-	Shock Absorber, Gabriel #57111	2 1/2" springs	2
4	-	Shock Absorber, Delco #5544716	3" springs and Tandem	2
4	-	Shock Absorber, Gabriel #78139	H.D. Shock Abs.	2
5	-	Washer, Retainer, Gabriel #401429	2 1/2" springs	4
5	-	Washer, retainer, Gabriel #401750	3" springs and Tandem	4
5	-	Washer, retainer, Gabriel #401750	H.D. Shock Abs.	4